

Gas Hob

USER MANUAL

**MG75GQ095AH1B-EU/MG60GM097AH2B-EU/
MHR 604 FX G/MHR 604 FX /MH 705 TC FX G/
MH 705 TC FX /MH 604 FX G/MH 604LX/
MH 604FX /MH 604 TC FX/MH 604 TC FX G**

Warning notices: Before using this product, please read this manual carefully and keep it for future reference. The design and specifications are subject to change without prior notice for product improvement. Consult with your dealer or manufacturer for details. The diagram above is just for reference. Please take the appearance of the actual product as the standard.

SPECIFICATIONS

Description of the appliance

Model	Top Plate	Dimension (W*D*H)	Ignition device	Gas Connection	Electric supply	Burner Feature	ΣQn
MHR 604 FX G/ MHR 604 FX	Stainless Steel	600*510*90	Continuous Ignition Type	G1/2 thread	220-240V-50Hz-60Hz, 2W	Rapid (2), Semi-rapid(1), Auxiliary (1)	8.75kW
MH 705 TC FX/ MH 705 TC FX G	Stainless Steel	750*510*90				Triple-Crown(1), Rapid(1), Semi-rapid(2), Auxiliary(1),	11.5kW
MG75GQ095 AH1B-EU	Glass	750*510*90					
MH 604LX	Stainless Steel	600*510*95				Rapid (1), Semi-rapid(2), Auxiliary (1)	7.5kW
MH 604FX/ MH 604 FX G		594*514*90					
MH 604 TC FX/ MH 604 TC FX G	Stainless Steel	594*514*90				Triple-Crown(1), Semi-rapid(2), Auxiliary(1)	8.5kW
MG60GM09 7AH2B-EU	Glass	600*520*99				Triple-Crown(1) Semi-rapid(2), Auxiliary(1)	8.5kW

Gas Specification

Model	Gas type& pressure	Heat input and orifice size marked(mm)			
		Triple-Crown	Rapid	Semi-rapid	Auxiliary
		4.0kW(291g/h)	3.0kW(218g/h)	1.75kW(127.5g/h)	1.0kW(73g/h)
MHR 604 FX G/ MHR 604 FX	G30 29mbar	/	0.87	0.66	0.50
	G20 20mbar	/	1.30	1.00	0.78
MH 705 TC FX/ MH 705 TC FX G/ MG75GQ095 AH1B-EU	G30 29mbar	1.00	0.87	0.66	0.50
	G20 20mbar	1.50	1.30	1.00	0.78
MH 604LX/ MH 604FX/ MH 604 FX G	G30 29mbar	/	0.87	0.66	0.50
	G20 20mbar	/	1.30	1.00	0.78
MH 604 TC FX/ MH 604 TC FX G/ MG60GM097AH2 B-EU	G30 29mbar	1.00	/	0.66	0.50
	G20 20mbar	1.50	/	1.00	0.78

PRODUCT OVERVIEW

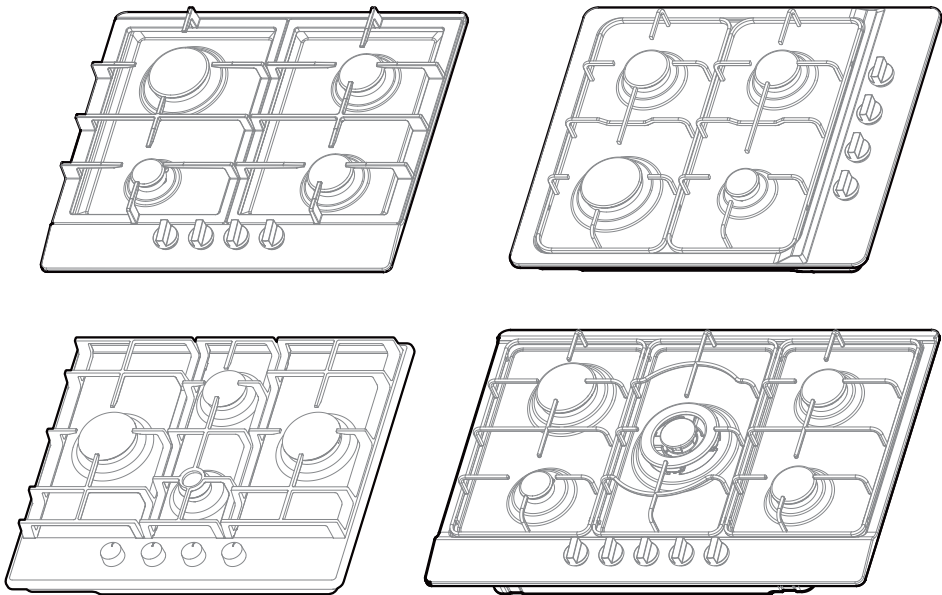

The diagram above is just for reference. Please take the appearance of the actual product as the standard.

Accessories

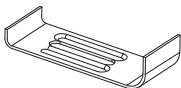

Bracket 4



Sponge 4



Screw 4



Instruction Manual 1



Injector 4
(Injector 5
MG75GQ095AH1B-EU/
MH 705 TC FX/
MH 705 TC FX G)



Sealing gasket
(Quantity based on
actual product)

PRODUCT INSTALLATION

Positioning

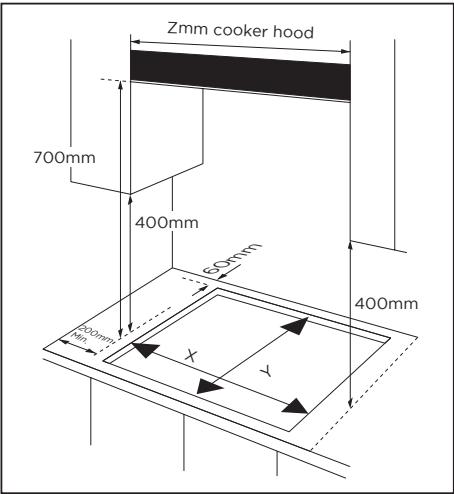

CLEARANCES REQUIRED WHEN FITTING WITH A COOKER HOOD

Model	X	Y	Z
MH 604LX	560	480	600
MH 705 TC FX MH 705 TC FX G MG75GQ095AH1B-EU	560	480	750
MHR 604 FX MHR 604 FX G MH 604FX MH 604 FX G MH 604 TC FX MH 604 TC FX G MG60GM097AH2B-EU	560	490	600

This appliance is to be built into a kitchen unit or 600mm worktop, providing the following minimum distances are allowed;

- The edges of the hob must be a minimum distance of 60 mm from a side or rear wall.
- 700 mm between the highest point of the hob surface (including the burners) and the underside of any horizontal surface directly above it.
- 400 mm between the hob surfaces, providing that the underside of the horizontal surface is in line with the outer edge of the hob. If the underside of the horizontal surface is lower than 400 mm, then it must be at least 50 mm away from the outer edges of the hob.
- 50 mm clearance around the appliance and between the hob surface and any combustible materials.
- You must have a gap of at least 25 mm and at most 74 mm between the underneath of the appliance and any surface that is below it.

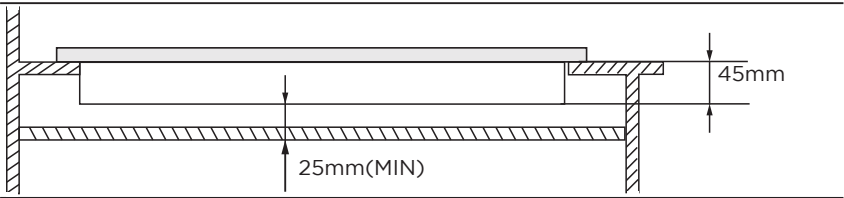

- An oven must have forced ventilation to install a hob above it.
- Check the dimensions of the oven in the installation manual.
- The cut out size must obey the indication.

Installing the appliance

- Remove the pan supports, the burner lid and flame spreader and carefully turn the appliance upside down and place it on a cushioned mat.
Take care that the Ignition devices and flame supervision devices are not damaged in this operation.
- Apply the sponge provided around the edge of the appliance.
- Do not leave a gap in the sealing agent or overlap the thickness.

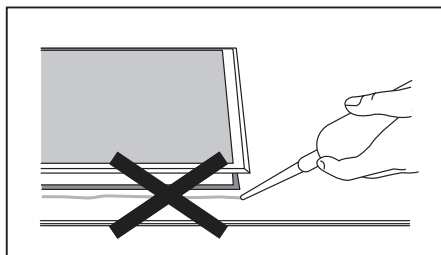

Warning

- Do not use a silicon sealant to seal the appliance against the aperture.
This will make it difficult to remove the appliance from the aperture in future, particularly if it needs to be serviced.

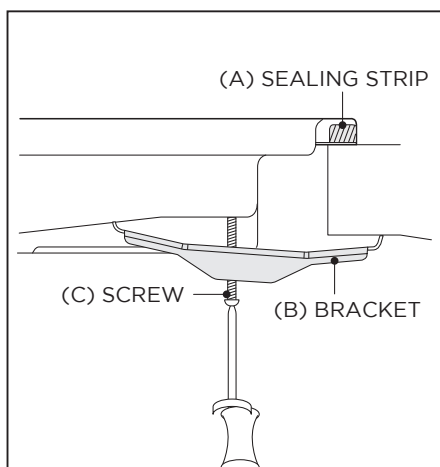

1. Place the bracket (B) over the holes that match the size of the screws. There are one set of screw holes in each corner of the hob (H). Slightly tighten a screw (C) through the bracket (B) so that the bracket is attached to the hob, but so that you can still adjust the position.
2. Carefully turn the hob back over and then gently lower it into the aperture hole that you have cut out.
3. On the underneath of the hob, adjust the brackets into a position that is suitable for your worktop.
Then fully tighten the screws (C) to secure the hob into position.



make yourself at home



www.midea.com